

## CS1-F Series

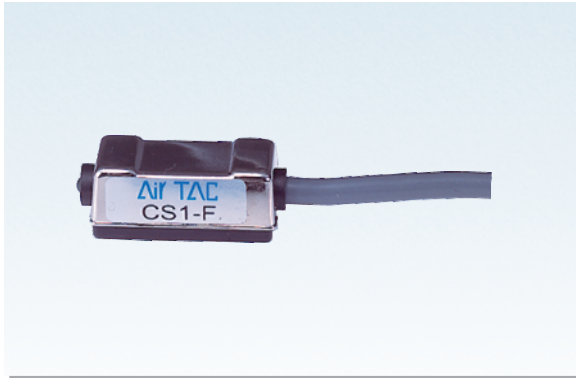

### ■ Dimensions

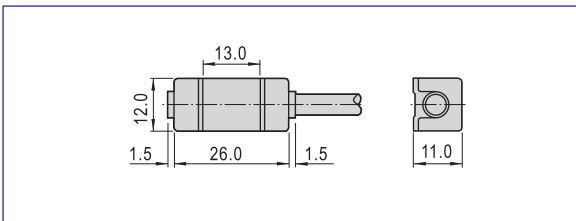

### ■ The ordering code of mounting accessories

Bore size\Series	SC,SCL	SU,SUL	SI,SIL	JSI
32	F-SC32H	F-SU32H	F-SI32H	F-SI32H
40	F-SC32H	F-SU40H	F-SI40H	F-SI40H
50	F-SC32H	F-SU50H	F-SI50H	F-SI50H
63	F-SC63H	F-SU63H	F-SI63H	F-SI63H
80	F-SC80H	F-SU80H	F-SI80H	F-SI80H
100	F-SC80H	F-SU100H	F-SI100H	F-SI100H
125	-	-	F-SI125H	F-SI125H
160	-	-	F-SI160H	-
200	-	-	F-SI200H	-

### ■ Specification

Item\Type	CS1-F	CS1-FX
Switch logic	STSP Normally opened type	
Switch type	Reed switch with contact	
Operating voltage(V)	5~240V AC/DC	
Max. Switching current(mA)	100	
Switching rating(W)	Max. 10	
Current consumption	No	
Voltage drop	2.5V Max. @100mA DC	
Cable	Φ4.0,2C Gray oil resistant PVC (Flame retarded)	
Indicator	Red LED	No
Leakage current	No	
Sensitivity(Gauss)	60~75	
Max. Frequency(Hz)	200	
Shock(m/s <sup>2</sup> )	300	
Vibration(m/s <sup>2</sup> )	90	
Temperature range(°C) ①	-10~70	
Enclosure classification	IP67(NEMA6)	
Protection circuit	No	

① Note: Please contact us for high temperature resistant(125°C),low temperature resistant(-40~-25°C) and explosion-proof sensor switch.

### ■ Ordering code

**CS1 F X 020**

- **Number of sensor switch**  
CS1: Sensor switch
- **Specification of sensor switch**

Specification	Product Series
F: F type	SI, SU, SC, JSI/MI/MA50(63)
- **Model of sensor switch**

Blank: two-line magnetic spring pipe with contact/normally opened
X: two-line magnetic spring pipe with contact, without indicator light/normally opened
- **Connecting way** ①

C08: M8 quick joint, length of wire is 150mm
C12: M12 quick joint, length of wire is 150mm
020: length of wire is 2m
030: length of wire is 3m
050: length of wire is 5m
100: length of wire is 10m

① Note: The quick joint that is attached at the end of wire is three-needle-male joint-linear-rotary screw thread type. The female joint plug has to be ordered additionally. Please refer to P420 for the specific data.

### ■ Mounting

Installation example	Installation method
<p>Fastening screw, Sensor switch, Mounting bracket, Fastening screw, Body</p> <p>Outline 1: Used with SU, SI, JSI series</p>	<p>When the CS1-F, CS1-FX series sensor switch used with different cylinders, different mounting accessories must be ordered. the details are below.</p> <ol style="list-style-type: none"> <li>When it used with MI, MA50, 63 series cylinders, you must order the band unit(the ordering code is GXPAB-01), then depend on the below outline 3, fixed the sensor switch on the proper position of the cylinder's body with the band unit.</li> <li>When it used with SC series cylinders, you must order the Mounting bracket ( the ordering code is below table ), then depend on the below outline 2, fixed the sensor switch on the proper position of the cylinder's body with the mounting bracket.</li> <li>When it used with SU, SI, JSI cylinders, you must order the mounting bracket( the ordering code is below table), then depend on the below outline 1, fixed the sensor switch on the proper position of the cylinder's body with the mounting bracket.</li> </ol>
<p>Sensor switch, Body, Mounting bracket, Fastening screw, Tie rod</p> <p>Outline 2: Used with SC series</p>	
<p>Mounting accessories, Fastening screw, Band unit, Sensor switch, Body</p> <p>Outline 3: Used with MI, MA series</p>	



Sensor switch

